

OWNER'S ACKNOWLEDGMENTS AND DEDICATIONS

STATE OF TEXAS
 COUNTY OF HAYS

I, Brian McCoy - Secretary, McCoy Realty Corp., owner and developer of a 3.159 acre tract, being part of the 7.791 acre tract as recorded in Volume 2366, Page 232 of the Official Records of Brazos County, Texas, and designated herein as Lots 2 through 4, Block 1 of McCoy's-Cole Subdivision, and whose name is subscribed hereto, hereby dedicate to the use of the public forever all streets, alleys, parks, water courses, drains, easements and public places thereon shown for the purpose and consideration therein expressed.

Brian McCoy
 Brian McCoy - Secretary, McCoy Realty

STATE OF TEXAS
 COUNTY OF HAYS

Before me, the undersigned authority, on this day personally appeared Brian McCoy, known to me to be the person whose name is subscribed to the foregoing instrument and acknowledged to me that he executed the same for the purposes and considerations therein stated. Given under my hand and seal this 11 day of November, 1995.



Nancy I. Rodriguez
 Notary Public in and for the State of Texas
 Printed Name: Nancy I. Rodriguez
 My Commission Expires:

CERTIFICATE OF SURVEYOR

I, S. M. Kling, Registered Professional Land Surveyor No. 2003, in the State of Texas, hereby certify that this plat is true and correct and accurately represents the lines and dimensions of the property, was prepared from an actual survey of the property made under my supervision on the ground, and that it indicates all easements as they are visible on the ground, and that there are no encroachments, conflicts or protrusions, except as shown hereon.



S.M. Kling
 S. M. Kling, R.P.L.S. No. 2003
 Date:

APPROVAL OF THE CITY ENGINEER

I, Bruce Karr, P.E., City Engineer of the City of Bryan, hereby certify that this plat is in compliance with the appropriate codes and ordinances of the City of Bryan.

Bruce Karr
 Bruce Karr, P.E. - City Engineer
 City of Bryan, Texas

APPROVAL OF THE PLANNING AND ZONING COMMISSION

I, John Godfrey, Chairman of the Bryan Planning and Zoning Commission, hereby certify that the attached plat was duly filed for approval with the City Planning Commission of the City of Bryan on the 20th day of October, 1995, and same was duly approved on the 2nd day of November, 1995.

John Godfrey
 John Godfrey, Chairman, Bryan Planning and Zoning Commission
 City of Bryan, Texas

CERTIFICATE OF COUNTY CLERK

STATE OF TEXAS
 COUNTY OF BRAZOS

I, Mary Ward, County Clerk, in and for said County, do hereby certify that this plat together with its certificates of authentication was filed for record in my office the 11 day of November, 1995, in the Official Records of Brazos County, Texas, in Volume 2445, Page 153.

Witness my hand and official seal, at my office in Bryan, Texas.

Mary Ward
 Mary Ward, County Clerk, Brazos County

CERTIFICATE OF CITY PLANNER

I, Refeek Shanaa, Ph.D., City Planner of the City of Bryan, hereby certify that the plat conforms to the City Master Plan, Major Street Plan, Land Use Plan, and the Standards and Specifications set forth in this Ordinance.

Refeek Shanaa
 Refeek Shanaa, Ph.D., City Planner
 City of Bryan, Texas

**AMENDING PLAT
 OF
 McCOY'S - COLE SUBDIVISION
 PHASE II - LOTS 2 TO 4
 BLOCK 1**

3.159 ACRE TRACT

JOHN AUSTIN SURVEY, A-2
 BRYAN, BRAZOS COUNTY, TEXAS
 OWNED AND DEVELOPED BY:
 McCOY REALTY CORP.
 P.O. Box 1028
 SAN MARCOS, TEXAS 78666-1028

SCALE: 1" = 50' AUGUST, 1995

PREPARED BY:
 KLING ENGINEERING & SURVEYING

4103 TEXAS AV. + P.O. BOX 4234 + BRYAN, TEXAS + PH.409/846-6212

THE SOLE PURPOSE OF THIS AMENDING PLAT IS TO CORRECT THE OWNER'S ACKNOWLEDGMENT TO BE APPLICABLE TO PHASE II

FILED
 95 NOV 21 PM 3:49
 CLERK
 BRAZOS COUNTY CLERK'S OFFICE
Sheri Talma
 DEPUTY
 493476

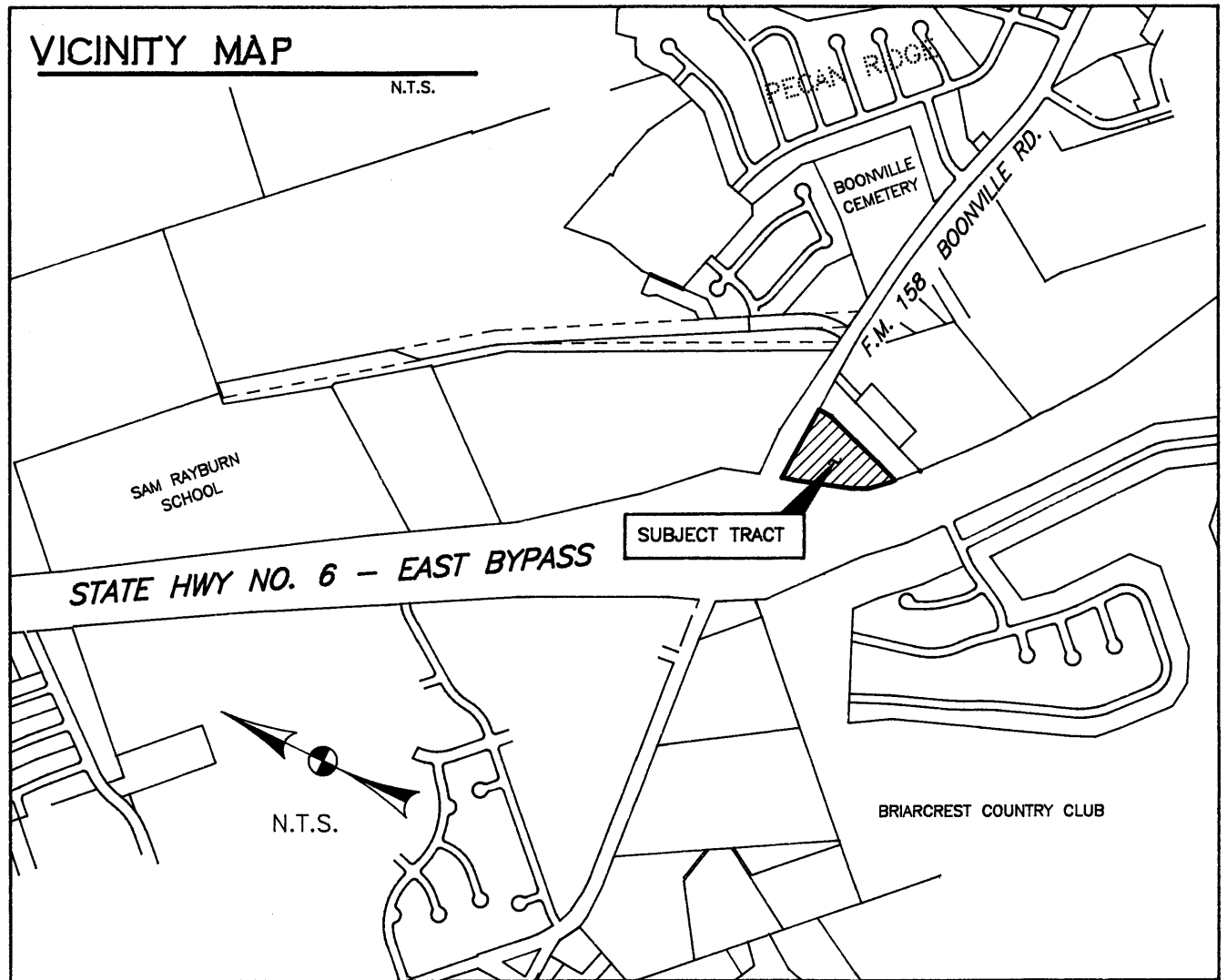

NOTE:
 AT THE INSTRUCTION OF THE CITY OF BRYAN ELECTRICAL DEPARTMENT, THE 20' ELECTRICAL ESMT. RECORDED IN VOL. 98 PG. 357 (NO DEFINED LOCATION GIVEN) IS APPLICABLE TO THE EXISTING ELECTRICAL TRANSMISSION LINE ADJOINING F.M. 158. THE 20' EASEMENT IS CENTERED ON THE LINE AS CONSTRUCTED AND THAT PART OF THE EASEMENT AFFECTING THIS PLAT HAS BEEN SHOWN. IN ADDITION TO THIS EXISTING EASEMENT, AND BY VIRTUE OF THIS PLAT, AN EXCLUSIVE 25' CITY OF BRYAN UTILITY EASEMENT IS CREATED ALONG F.M. 158 AS SHOWN ON THIS PLAT.

on line base wd qilibi